

2009 Edition

ACTIS THIN
MULTIFOIL INSULATION

TRISO-SOLS

DATA SHEET



FLOORS WITH
HOT WATER
UNDERFLOOR
HEATING SYSTEMS
UNDER SCREED

EUROPEAN TECHNICAL
APPROVAL IN PROCESS
Registration N° 12.01/12

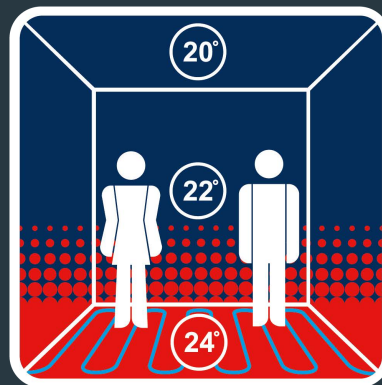

GS UNDERFLOOR
HEATING

INSULATION OF FLOORS WITH HOT WATER UNDERFLOOR HEATING SYSTEMS AND UNDER SCREED

SPECIAL BENEFITS

- Ideal for renovation: preserves headroom (just 7mm thick).
- Uniformly reflects the heat from hot water underfloor heating systems back up into the room
- Eliminates thermal bridging at floor perimeters, no need for separate edge strips.
- Polythene film with grid markings facilitates laying of heating pipes.

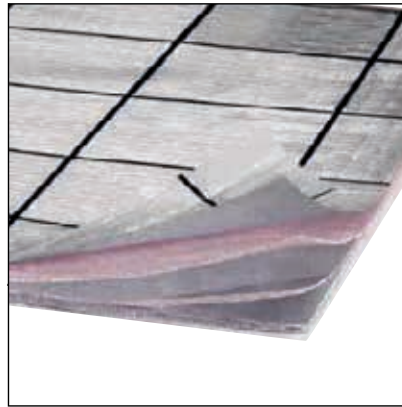

ADVANTAGES

- Space saving.
- Clean and free from irritant fibres.
- Durable.
- Quick and easy to install: flexible, can be cut with scissors or ACTIS CUTTER.
- Light, easy to transport.

TECHNICAL CHARACTERISTICS

PRODUCT DESCRIPTION

13 components:

- 2 reflective foils with reinforcing mesh
- 4 internal reflective foils
- 6 foam layers
- 1 polythene film with grid markings

Number of reflective foils: 6
Thickness: 7mm approx.

PROPERTIES

VALUE

REFERENCE STANDARD

Acoustic Insulation

- Insulation against impact noise

$\Delta I = 21$ dB

Mechanical Resistance

- Breaking strength Warp
- Breaking strength Weft
- Tear strength Warp
- Tear strength Weft

> 500N
> 400N
> 60N
> 60N

EN ISO 13934-1
EN ISO 13937-2

Packaging

20m²

Width 1.60m
Length 12.50m
Weight (per roll approx.) 10kg

FLOORS WITH HOT WATER UNDERFLOOR HEATING SYSTEMS

1 PREPARATION

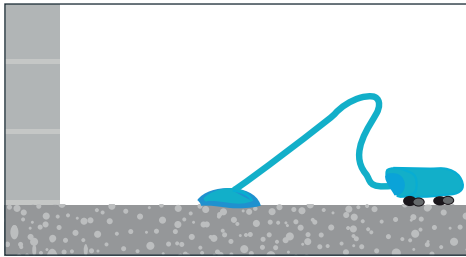

- Prepare the floor by ensuring that it is clean, dry and even.

2 LAYING THE FIRST STRIP

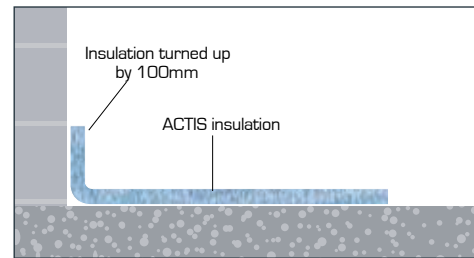

- Roll the insulation out on the floor.
- Turn the insulation up at the walls by 100 to 150mm to insulate floor edges.

3 LAYING THE FOLLOWING STRIPS

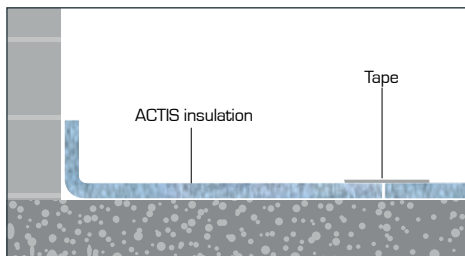

- Do not overlap the two strips of insulation, instead butt the second strip up against the first. Only the polythene film should overlap.
- Cover the joints with tape.

4 FINISH

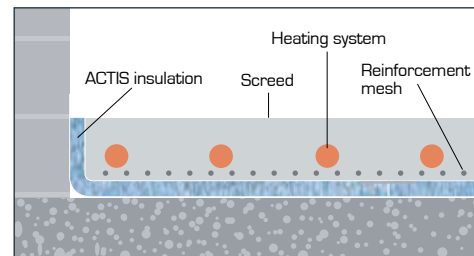

- Fit the hot water underfloor heating system and screed to manufacturers' specifications and in accordance with the relevant regulations.
- Polythene film with grid markings facilitates laying of heating pipes.

INSTALLATION UNDER A SCREED

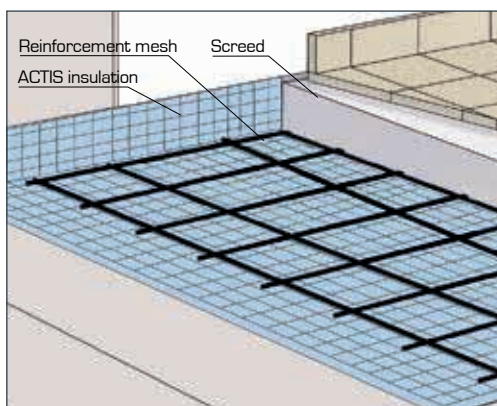

- TRISO-SOLS can be used under a screed, with or without hot water underfloor heating, either on its own or laid over another insulation product.
- TRISO-SOLS can be used to insulate against impact noise.



ACTIS Cutter

Simultaneously cuts through all layers of ACTIS insulation products.



ACTIS ISODHESIF tape

SAFETY PRECAUTIONS AND RECOMMENDATIONS

How to get the most from your ACTIS product

IMPORTANT: in addition to the specific recommendations given by ACTIS below, your ACTIS product should be installed and used in compliance with (1) good building practice; (2) the most recent editions of any applicable regulations or relevant guidance and (3) any British or European Standards relating to the installation and use of insulation products, particularly in relation to safety precautions.

■ Safety precautions to observe in relation to your ACTIS product

The European classification system for reaction to fire is called the Euroclass system. The system defines fire performance based on the following:

- Reaction to fire (classification from A to F).
- Smoke production: the emission of smoke and its opacity (classification from 1-3).
- Flaming droplets or particles (classification from 0-2).

TRISO-SOLS is not fire rated, and has Euroclass classification F.

• Fire precautions

Never expose ACTIS insulation to a direct heat source, sparks or a naked flame.

Keep blow torches well away from ACTIS insulation, even when using a flame guard or other protective device, and make sure that hot debris and sparks do not make contact with the insulation.

• Fireproof finishes and compartment walls

As recommended by current regulatory guidance, do not leave insulation exposed in habitable rooms. We recommend that ACTIS insulation is always covered with a fireproof finish (see, for example, the fire safety provisions contained in Approved Document B, which provides practical guidance on the fire safety requirements of the Building Regulations 2000 (as amended) in England and Wales; or refer to the relevant provisions in Scotland and Northern Ireland, as amended from time to time).

• Chimneys, inserts, heat exchangers and other sources of heat

Never use ACTIS insulation to insulate a chimney flue, an insert, heat exchanger or any other heat source above 80°C. Use a Euroclass A1 non-combustible insulation in compliance with British or European Standards. ACTIS advise leaving a minimum gap of 200 mm between the insulation and chimneys, inserts, heat exchangers and all other sources of heat above 80°C.

Please seek advice from ACTIS by calling the helpline on 01249 462 888 and check with your local Building Control officer before installing ACTIS insulation near any source of heat about 80°C.

• Contact between materials and compatibility between products

Avoid all contact between ACTIS insulation and lead, zinc, copper and its alloys as well as caustic products.

■ General guidance on installing your ACTIS insulation

Insulation should take into account all elements of the building envelope which are susceptible to thermal losses, such as doors, windows, roofs, chimneys, walls and floors. Adequate ventilation should be provided where necessary, in compliance with good building practice and with the most recent editions of the relevant regulatory guidance and British and European Standards available.

ACTIS cannot compensate for heat losses due to defective or poorly insulated joinery, or thermal bridging due to poor construction.

ACTIS makes no warranty, express or implied, as to the performance of its products if the relevant installation guidelines are not followed.

• Direction of laying ACTIS insulation materials

TRISO-SOLS should be installed with the polythene film with grid markings facing upwards.

• Protecting your ACTIS product from the elements before and after installation

ACTIS insulation should be stored in its packaging under cover to protect it from the elements (such as rain or snow). During installation, ACTIS insulation should be protected from any prolonged exposure to rain or snow. Once installed, ACTIS insulation should not be left exposed to weathering for more than 3 days.

• Installing other products with your ACTIS product

When using ACTIS insulation in conjunction with other products or with supplementary insulation, precautions must be taken to avoid vapour or condensation issues. ACTIS cannot make any warranty, express or implied, as to the performance or safety of other products used in conjunction with its own products.